

4 SOFFIT DETAIL  
3" = 1'-0" | RE:2/A350

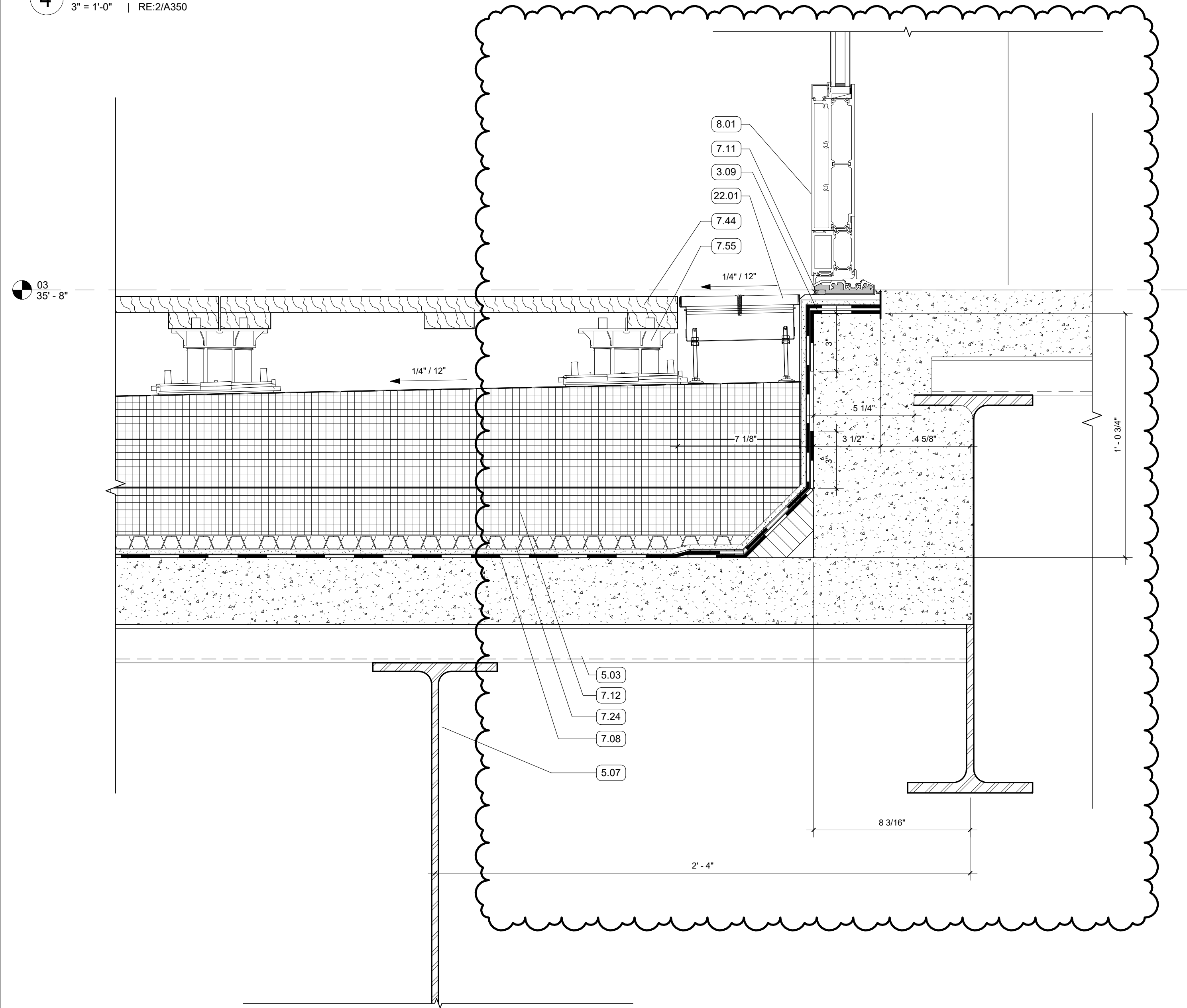

1 ROOF DETAIL  
3" = 1'-0" | RE:1/A103

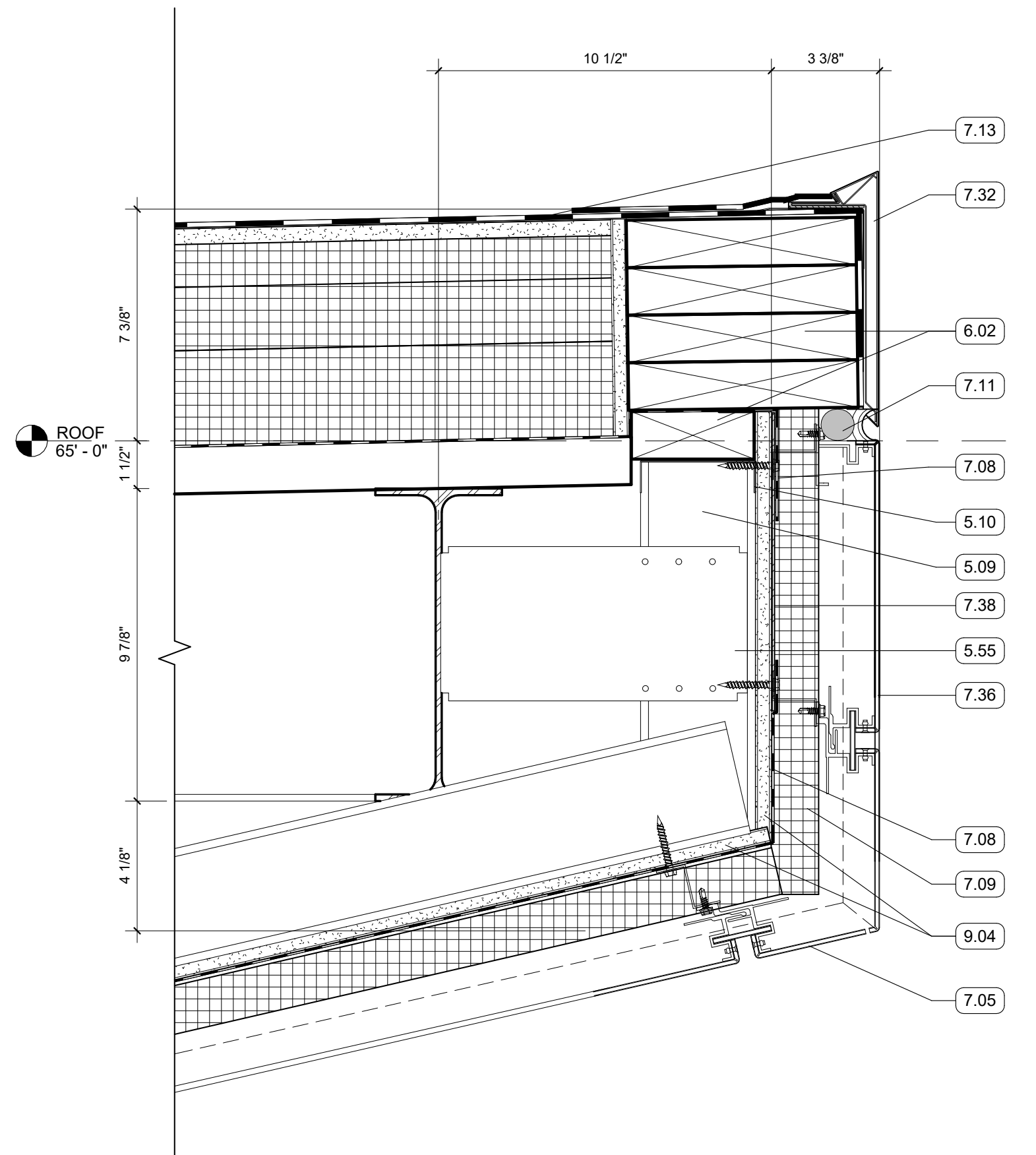

2 SOUTH THROUGH VESTIBULE UPPER - Callout 3  
3" = 1'-0" | RE:3/A351

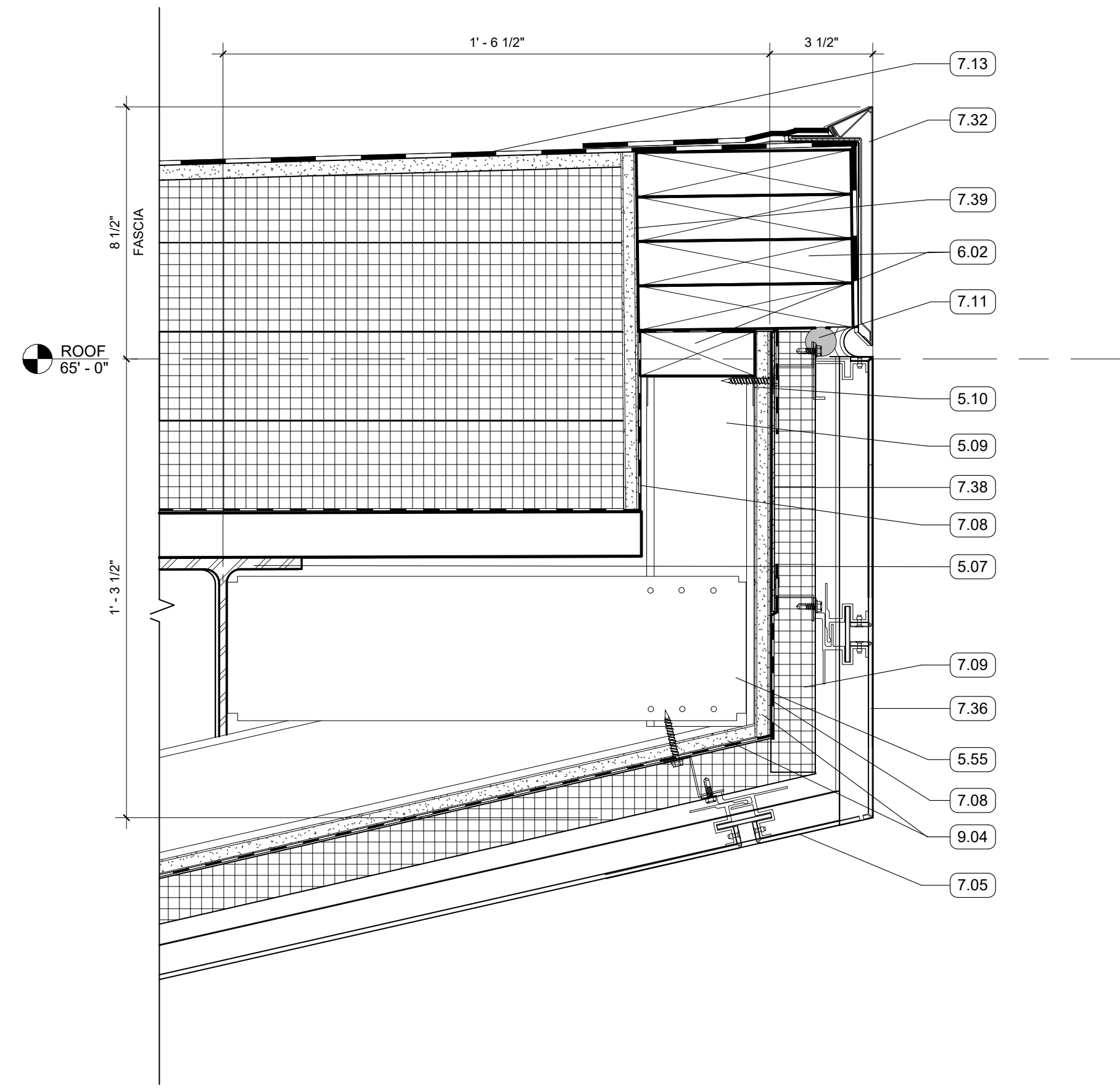

3 X2  
3" = 1'-0" | RE:3/A352

GENERAL NOTES

KEYNOTES

- 3.09 RECESS SLAB AS NECESSARY TO MAINTAIN AN ACCESSIBLE THRESHOLD CONDITION
- 5.03 5 1/2" COMPOSITE MTL DECK AND CONCRETE SLAB
- 5.05 6" METAL TRACK
- 5.06 6" METAL STUD FRAMING
- 5.07 STRUCTURAL STEEL FRAMING
- 5.09 3 5/8" METAL STUD FRAMING
- 5.10 3 5/8" METAL TRACK
- 5.54 BRAKE METAL TRIM
- 5.55 UNIVERSAL BYPASS STEEL CLIP
- 6.02 WOOD BLOCKING
- 7.05 MCM PANEL SOFFIT
- 7.06 BATT INSULATION, SIZED TO MATCH STUD DEPTH
- 7.08 PROTECTION COURSE
- 7.09 MINERAL FIBER BOARD INSULATION
- 7.11 BACKER ROD AND SEALANT
- 7.12 2 1/2" POLYISO INSULATION
- 7.13 2 PLY SBS ROOFING SYSTEM
- 7.24 ROOF DRAINAGE MAT
- 7.32 GRAVEL STOP FASCIA
- 7.36 MCM PANEL
- 7.38 SELF-ADHERED FLASHING
- 7.39 TRANSITION MEMBRANE
- 7.44 WOOD PAYER TILES: SEE LANDSCAPE FOR TILE LAYOUT PATTERN
- 7.55 ADJUSTABLE PEDESTALS
- 8.01 ALUM STOREFRONT, CURTAINWALL, OR WINDOW SYSTEM. SEE OPENING SCHEDULE
- 8.09 BACK PANEL
- 9.01 5/8" GYPSUM BOARD; SEE FINISH PLAN FOR FINISH MATERIAL
- 9.04 5/8" EXTERIOR SHEATHING
- 22.01 TRENCH DRAIN - CONNECT TO PLUMBING